

PALISADE™

Waterproof, Grout-Free Shower Wall System

Shower Wall System Installation

READ this entire installation guide before beginning your installation. ACP is not responsible and will not be held liable for project failures if installation guidelines are not followed. ACP recommends that you install these tiles over an existing substrate to ensure proper structural integrity. Palisade tiles are not intended to be attached to raw concrete, poured concrete walls or concrete block basement walls.

FOR SHOWER, TUB OR DIRECT WATER ENVIRONMENTS

Although Palisade tiles are 100% waterproof when used with sealant in the seams, we recommend you follow your local building codes for wet environments like shower and tub enclosures. In a tub or shower area, existing ceramic tile walls can be covered with no additional preparation. Otherwise,

installation over a waterproof substrate is required, such as Cement Board®, Schluter Kerdi Board®, GP Densheid®, Johns Manville Go Board®, Hardiebacker®, WPBK Triton®, Fiberock® and equivalent products. Always follow manufacturer's installation instructions to create a waterproof enclosure.

NOTE:

ACP, LLC is not responsible or liable for any labor costs or damaged product incurred as a result of improper installation. All product defects are covered under our 10-year limited warranty.

Due to manufacturing variations, we cannot guarantee an exact color match from lot to lot. Prior to installing Palisade tiles and trims on your walls, please unpackage & lay out all purchased product to ensure color consistency. If you encounter unreasonable color variation, please give us a call at 1-800-434-3750 (7am-4:30pm CST, M-F) so that we may assist you with your project.

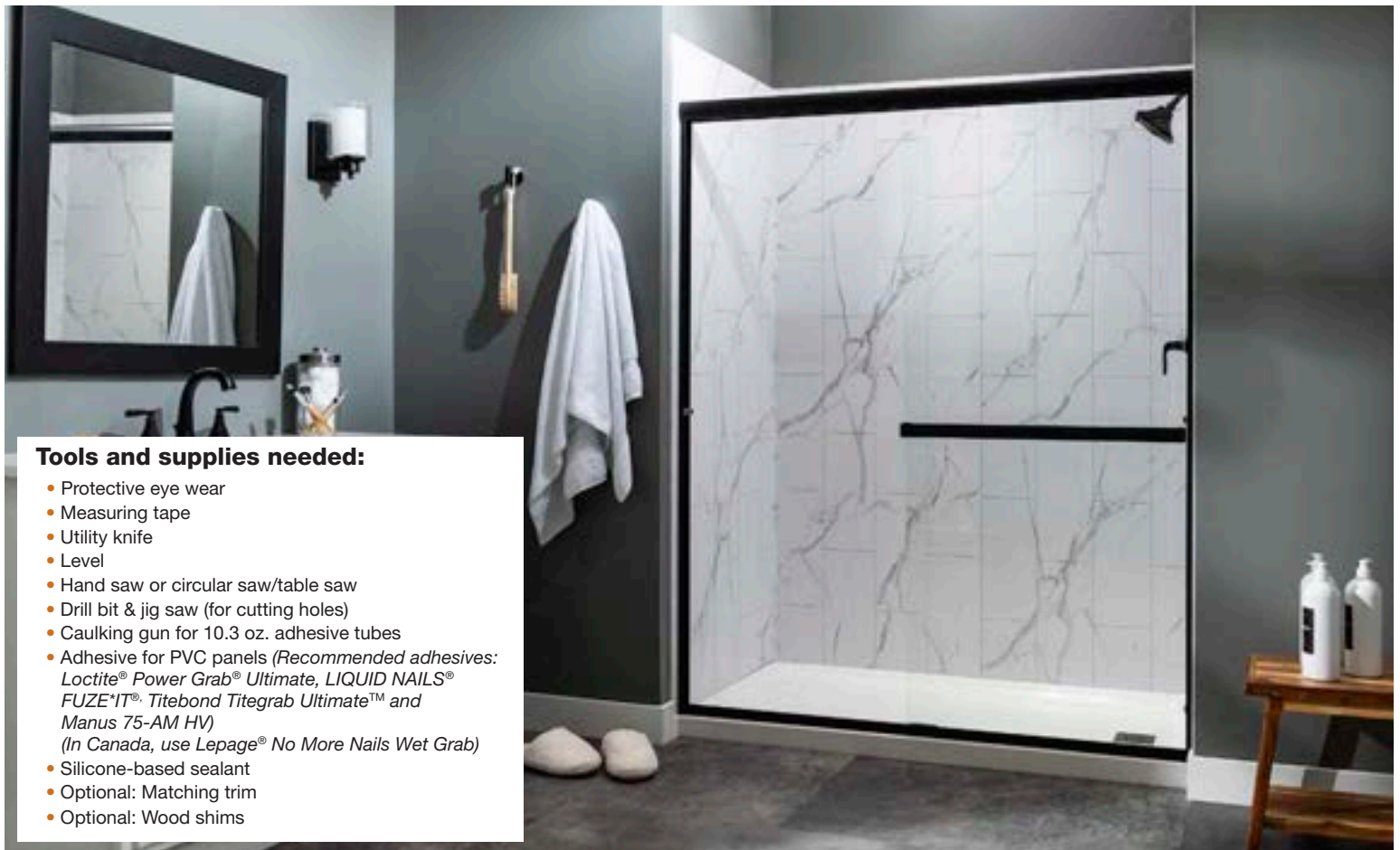

Tools and supplies needed:

- Protective eye wear
- Measuring tape
- Utility knife
- Level
- Hand saw or circular saw/table saw
- Drill bit & jig saw (for cutting holes)
- Caulking gun for 10.3 oz. adhesive tubes
- Adhesive for PVC panels (*Recommended adhesives: Loctite® Power Grab® Ultimate, LIQUID NAILS® FUZE*IT®. Titebond Titegrab Ultimate™ and Manus 75-AM HV*)
(*In Canada, use Lepage® No More Nails Wet Grab*)
- Silicone-based sealant
- Optional: Matching trim
- Optional: Wood shims

Universal Guide for these Shower Wall System Options:

Shower Size: 36" Depth 60" Wide x 36" Depth x 78" Tall

Panels Included:

- 2 - Interlocking Panels 30" x 78" = 60" Width
- 2 - Panels 36" x 78" = 36" Depth (Sides: R & L)

Matching Trims Included:

- 2 - J-Trim 78" tall
- 2 - L-Trim 78" tall
- 2 - Inside Corner Trim 78" tall

Shower Size: 32" Depth 60" Wide x 32" Depth x 78" Tall

Panels Included:

- 2 - Interlocking Panels 30" x 78" = 60" Width
- 2 - Panels 32" x 78" = 32" Depth (Sides: R & L)

Matching Trims Included:

- 2 - J-Trim 78" tall
- 2 - L-Trim 78" tall
- 2 - Inside Corner Trim 78" tall

Shower Size: 30" Depth 60" Wide x 30" Depth x 78" Tall

Panels Included:

- 2 - Interlocking Panels 30" x 78" = 60" Width
- 2 - Panels 30" x 78" = 30" Depth (Sides: R & L)

Matching Trims Included:

- 2 - J-Trim 78" tall
- 2 - L-Trim 78" tall
- 2 - Inside Corner Trim 78" tall

2-Wall Shower 36" Wide x 36" Depth x 78" Tall

Panels Included:

- 1 - Panels 36" x 78" = 36" Side 1 (R)
- 1 - Panels 36" x 78" = 36" Side 2 (L)

Matching Trims Included:

- 2 - J-Trim 78" tall
- 2 - L-Trim 78" tall
- 1 - Inside Corner Trim 78" tall



Note on Panel Sizes:

The panels included in the Palisade shower wall system are designed to be installed in a standard 60-inch wide shower system. As such, all panels measure nominally smaller than the stated size to allow for ease of handling when fitting the tongue and groove feature, and to accommodate the corner trims.

Preparation for installation

Before starting, make sure all surfaces are clean, dry, smooth, and free from dust, grease, wax, etc. Wipe the back surface of the panels with a clean cloth to remove dust or debris. Perform a "dry layout" prior to applying adhesive.

Measure walls, & check for level and square. Depending on dimensions and room construction, you may need to trim some panels accordingly.

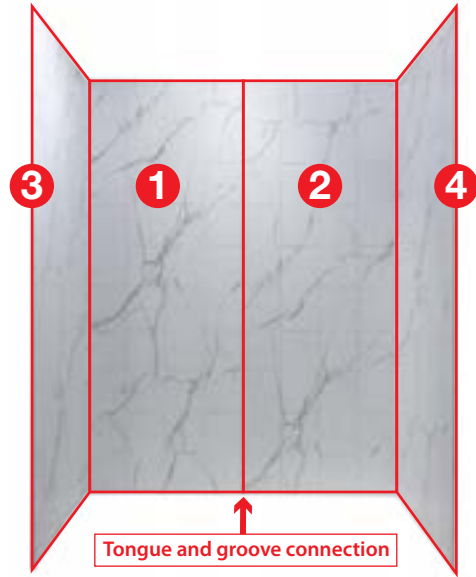

Install the back wall panels first, from left to right (1 & 2). Next, install the side wall panels (3 & 4). Note that panels 1 & 2 will connect together with tongue and groove, so pay attention ahead of install so that connection works.



Apply adhesive to the back of the first panel. Using recommended adhesive, apply a 1/8" bead around the perimeter of the panel, about 1" in from the edge. Then, apply rows of adhesive every 4-6" apart in a typical "S" pattern.



Insert sealant from end to end into the deeper channel of the first inside corner trim. Panel 1 will be inserted into this channel.

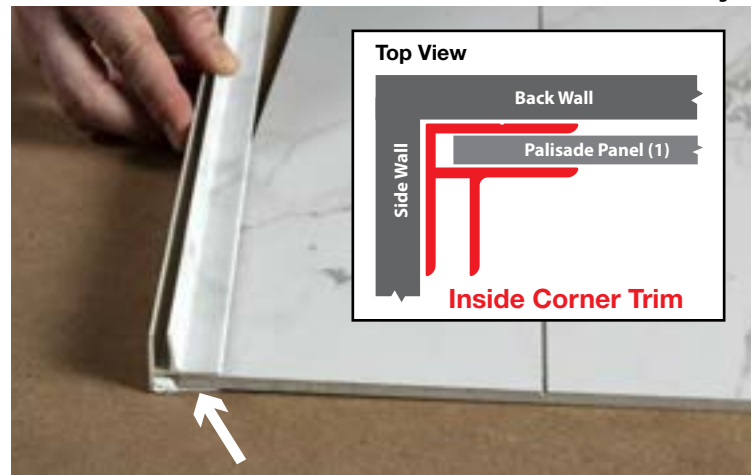

Slide the inside corner trim onto panel 1.

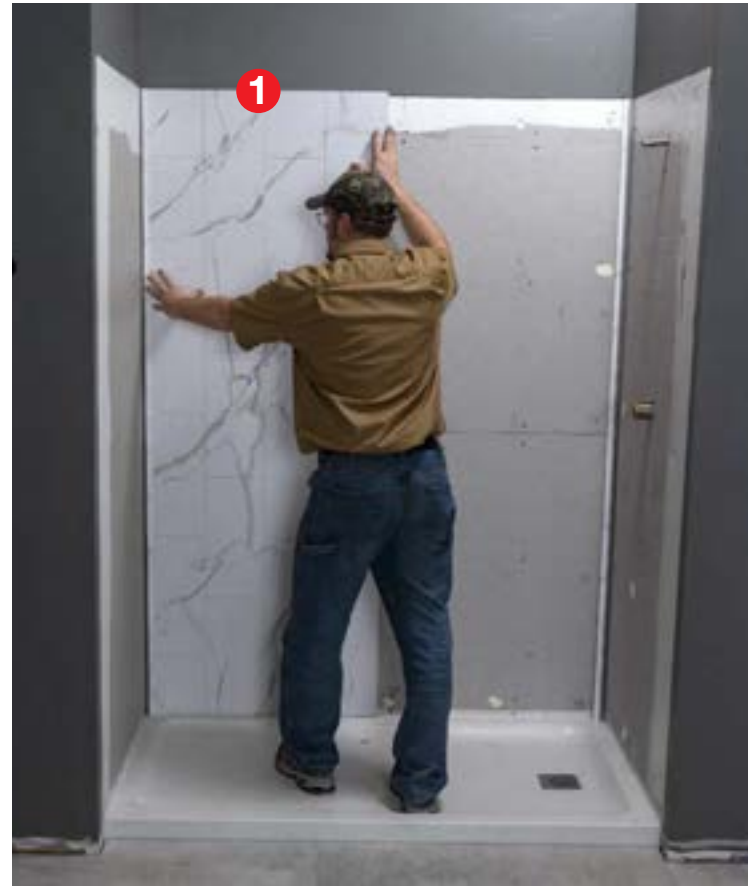

With the inside corner trim facing the left corner, and after applying adhesive to back of panel 1, press the panel onto the back wall. Make sure it is tight into the corner.



Before installing panel 2, be sure to put a bead of sealant along the tongue and groove of panel 1.

Like with panel 1, apply adhesive to the back of panel 2.

Insert sealant into the second inside corner trim from end to end. Slide the inside corner trim on panel 2. Like panel 1, make sure it is the deeper channel, as that is the one that panel 2 will go into.

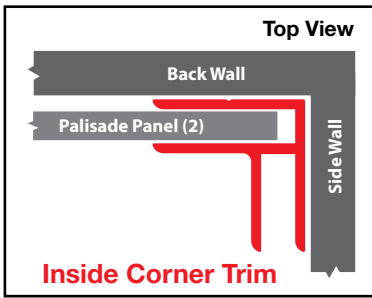

There is enough depth to the inside corner trim to allow plenty of panel movement to fit the panels together. Also, check for any sealant that may squeeze out of the inside corner trims that will need to be wiped off or if lacking you may need to apply more.



With the inside corner trim facing the right corner, press panel 2 onto the back wall. Make sure the corner trim and panel is tight in the corner.



Detail showing the tongue and groove connection.



Apply sealant into the other side of the inside corner trim that is already installed. Then apply adhesive to the back of panel 3 and affix to left wall and make sure it is inserted into the inside corner trim.

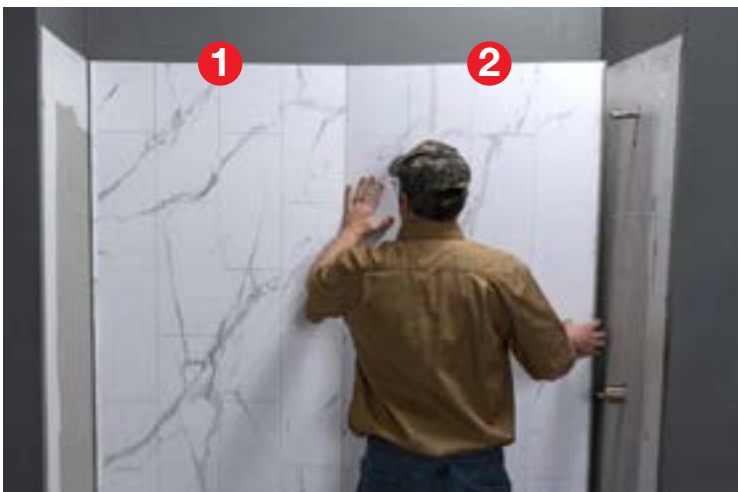

Slide the panel to the left so the tongue and groove of the panel edges click together. Wipe off any sealant that squeezes out or add more if needed.

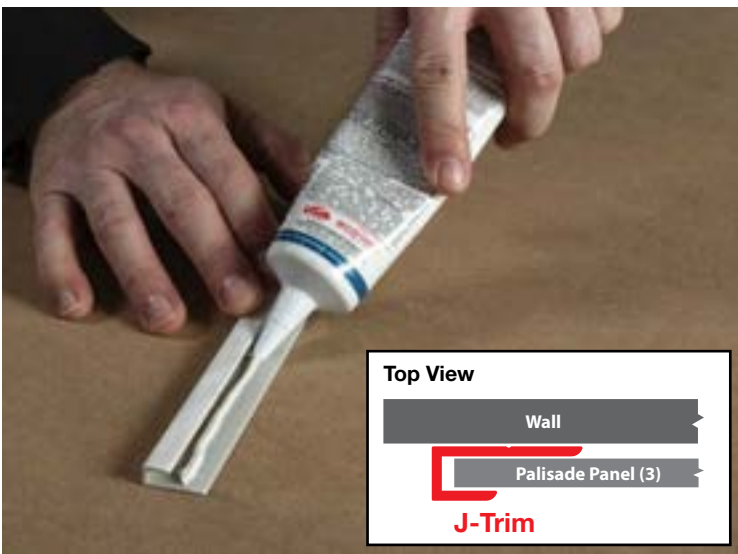

Apply adhesive into J-trim piece.



Cut panels to accommodate shower components. Measure and mark the locations and use one of these types of drills or hole saws.



Install the J-trim to cover the outside edge of panel 3.



Apply sealant into the other side of the inside corner trim that is already installed. Then apply adhesive to the back of panel 4 and affix to right wall and making sure it is inserted into the inside corner trim.



Also make sure it is fitting nicely to the plumbing.

L-Trim Option

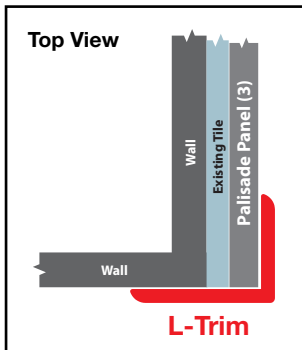

Note: If applying shower wall system over existing substrate such as tile, you will need to use L-trim which will better accommodate the thicker dimension of the wall.

Insert sealant into the second J-trim from end to end.

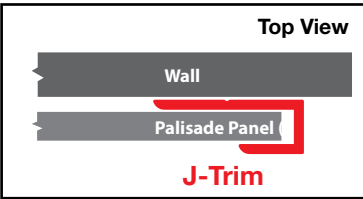

Install the J-trim to cover the outside edge of panel 4.



Completed shower wall system install.

For more information, or to get answers to Frequently Asked Questions (FAQs) about Palisade Shower Wall Systems, visit: Palisade-tiles.com



Apply sealant to top edges of all the panels for a watertight seal.



Smooth the sealant across the panels for adequate coverage.

PALISADE™
 Waterproof, Grout-Free Shower Wall System